

## Laser welded and longitudinally lock formed ducts, stainless steel

Diameter: ø80 - ø1000 mm.

Laser welded ducts are made of 0.70 mm sheet metal.

Longitudinally lock formed ducts are made of 0,80 mm sheet metal.

Ducts are supplied in 0.5 m, 1.0 m and 2.0 m lengths.

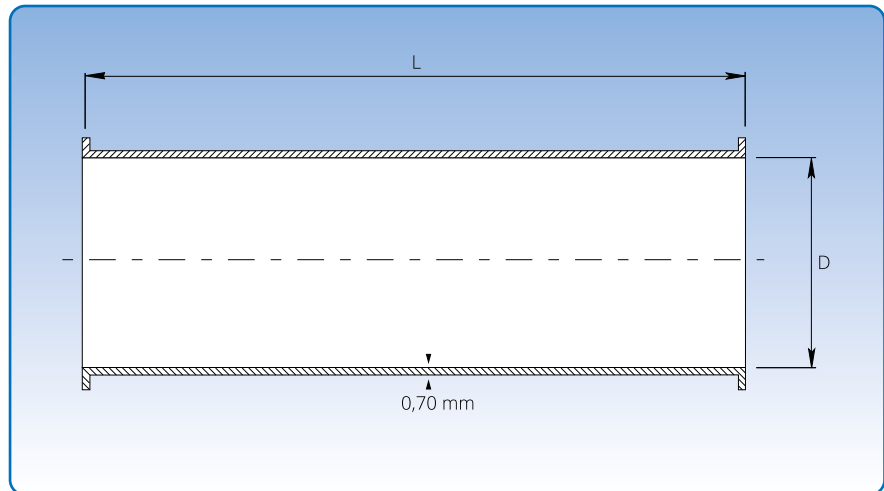

Dimensional specifications are given in the table below.

D mm	Item no. L = 0.5 m	Weight at L = 0.5 m kg	Dimensions		Item no. L = 2.0 m	Weight at L = 2.0 m kg
			Item no. L = 1.0 m	Weight at L = 1.0 m kg		
<b>Laser welded</b>						
80	10900011	0,70	10900021	1,41	10900031	2,81
100	10900111	0,88	10900121	1,76	10900131	3,52
120	10900211	1,06	10900221	2,11	10900231	4,22
125	10900311	0,97	10900321	2,33	10900331	4,28
140	10900411	1,23	10900421	2,46	10900431	4,93
150	10900511	1,32	10900521	2,64	10900531	5,28
160	10900611	1,49	10900621	2,99	10900631	5,60
175	10900711	1,58	10900721	3,17	10900731	6,33
180	10900751	1,44	10900761	2,88	10900771	5,28
200	10900811	1,76	10900821	3,52	10900831	7,04
224	10900911	1,98	10900921	3,96	10900931	7,92
250	10901011	2,20	10901021	4,40	10901031	8,80
300	10901211	2,64	10901221	5,28	10901231	10,56
315	10901311	3,20	10901321	5,18	10901331	10,56
350	10901411	3,08	10901421	6,16	10901431	12,32
400	10901511	3,52	10901521	7,04	10901531	14,07
<b>Longitudinally lock formed</b>						
450	10901711	5,15	10901721	10,30	10901731	20,60
500	10901911	5,70	10901921	11,40	10901931	22,80
550	10902011	6,25	10902021	12,50	10902031	25,00
600	10902111	6,80	10902121	13,60	10902131	27,20
630	10902211	7,20	10902221	14,40	10902231	28,80
650	10902311	7,50	10902321	15,00	10902331	30,00
700	10902411	8,00	10902421	16,00	10902431	32,00
750	10902511	8,50	10902521	17,00	10902531	34,00
800	10902611	10,00	10902621	20,00	10902631	40,00
850	10902711	22,20	10902721	32,95	10902731	54,45
900	10902811	23,60	10902821	35,10	10902831	48,10
950	10902911	24,99	10902921	37,24	10902931	51,74
1000	10903011	26,38	10903021	39,38	10903031	65,38

The item numbers stated are for ducts assembled using pull rings [f.b].

Laser welded ducts are also available for other assembly methods. See p. 5 for assembly methods.